

# Slant/Fin MONITRON

S2, S2M & LB



Electric Hot Water Boiler

## Boiler Replacement Parts List

This parts list must be left with owner, hung on or adjacent to the boiler. Owner should retain parts list for future reference.

ITEM	DESCRIPTION	PART NO.
1	M1, M2: WRAPPER WELD ASSEMBLY	790001000
2	M1: S2 8/9KW 1-PH ELECTRIC BOILER PARTITION ASSY	795120108
4	M1: S2 10KW 1-PH ELECTRIC BOILER PARTITION ASSY	795120110
5	M1: S2 12KW 1-PH ELECTRIC BOILER PARTITION ASSY	795120112
6	M1: S2 15KW 1-PH ELECTRIC BOILER PARTITION ASSY	795120115
8	M1: S2 16/18KW 1-PH ELECTRIC BOILER PARTITION ASSY	795120118
9	M1: S2 20KW 1-PH ELECTRIC BOILER PARTITION ASSY	795120120
10	M1: S2 24KW 1-PH ELECTRIC BOILER PARTITION ASSY	795120124
11	M1: S2 25KW 1-PH ELECTRIC BOILER PARTITION ASSY	795120125
12	M1: S2 28KW 1-PH ELECTRIC BOILER PARTITION ASSY	795120128
13	M1: S2 30KW 1-PH ELECTRIC BOILER PARTITION ASSY	795120130
14	M1: S2 32KW 1-PH ELECTRIC BOILER PARTITION ASSY	795120132
15	M1: S2 35KW 1-PH ELECTRIC BOILER PARTITION ASSY	795120135
17	M1: S2 40KW 1-PH ELECTRIC BOILER PARTITION ASSY	795120140
18	M1: S2 12KW 3-PH ELECTRIC BOILER PARTITION ASSY	795120312
19	M1: S2 15KW 3-PH ELECTRIC BOILER PARTITION ASSY	795120315
20	M1: S2 16KW 3-PH ELECTRIC BOILER PARTITION ASSY	795120316
21	M1: S2 18KW 3-PH ELECTRIC BOILER PARTITION ASSY	795120318
22	M1: S2 20KW 3-PH ELECTRIC BOILER PARTITION ASSY	795120320
23	M1: S2 24KW 3-PH ELECTRIC BOILER PARTITION ASSY	795120324
24	M1: S2 25KW 3-PH ELECTRIC BOILER PARTITION ASSY	795120325
25	M1: S2 28KW 3-PH ELECTRIC BOILER PARTITION ASSY	795120328
26	M1: S2 30KW 3-PH ELECTRIC BOILER PARTITION ASSY	795120330
27	M1: S2 32KW 3-PH ELECTRIC BOILER PARTITION ASSY	795120332
28	M1: S2 35KW 3-PH ELECTRIC BOILER PARTITION ASSY	795120335
30	M1: S2 40KW 3-PH ELECTRIC BOILER PARTITION ASSY	795120340
31	M1: CIRCUIT BREAKER COVER 3-BREAKERS	790940000
32	M1: CIRCUIT BREAKER COVER 5-BREAKERS	790941000
33	M1: CIRCUIT BREAKER COVER 7-BREAKERS	790942000
34	M1: CIRCUIT BREAKER COVER 9-BREAKERS	790943000
35	M1: CONTROL BOX COVER	790007000
36	M1, M2: LEFT END PLATE	790074000
37	M1, M2: RIGHT END PLATE	790011000
38	M1, M2: HEAT SHIELD PARTITION	790085000
39	COLLAR	790005000
402	M1: S2M 24KW 1-PH ELECTRIC BOILER PARTITION ASSY	795121124
403	M1: S2M 25KW 1-PH ELECTRIC BOILER PARTITION ASSY	795121125
404	M1: S2M 28KW 1-PH ELECTRIC BOILER PARTITION ASSY	795121128
405	M1: S2M 30KW 1-PH ELECTRIC BOILER PARTITION ASSY	795121130
406	M1: S2M 32KW 1-PH ELECTRIC BOILER PARTITION ASSY	795121132
407	M1: S2M 35KW 1-PH ELECTRIC BOILER PARTITION ASSY	795121135
408	M1: S2M 40KW 1-PH ELECTRIC BOILER PARTITION ASSY	795121140

ITEM	DESCRIPTION	PART NO.
40	M1, M2: 8KW HEAT EXCHANGER ASSY	792408000
41	M1, M2: 9KW HEAT EXCHANGER ASSY	792409000
42	M1, M2: 10KW HEAT EXCHANGER ASSY	792410000
43	M1, M2: 12KW HEAT EXCHANGER ASSY	792412000
44	M1, M2: 15KW HEAT EXCHANGER ASSY	792415000
45	M1, M2: 16KW HEAT EXCHANGER ASSY	792416000
46	M1, M2: 18KW HEAT EXCHANGER ASSY	792418000
47	M1, M2: 20KW HEAT EXCHANGER ASSY	792420000
48	M1, M2: 24KW HEAT EXCHANGER ASSY	792424000
49	M1, M2: 25KW HEAT EXCHANGER ASSY	792425000
50	M1, M2: 28KW HEAT EXCHANGER ASSY	792428000
51	M1, M2: 30KW HEAT EXCHANGER ASSY	792430000
52	M1, M2: 32KW HEAT EXCHANGER ASSY	792432000
53	M1, M2: 35KW HEAT EXCHANGER ASSY	792435000
55	M1, M2: 40KW HEAT EXCHANGER ASSY	792440000
60	HEX NUT 3/8-16 HEAVY	400145000
61	WASHER 3/8 X 13/16 X 1/16	400322000
62	SCREW 8x3/8 HEX WASHER ZN PLATE TYPE B	790834000
63	M1, M2: INSULATION (WRAPPER SIDE)	790201000
64	M1, M2: INSULATION (CENTER PARTITION SIDE)	790241000
65	WIRING LABEL	PER MODEL
66	"MONITRON" LABEL	790822000
67	"ENERGYGUIDE" LABEL	790854000
68	"DISCONNECT ALL POWER" LABEL	790859000
69	LABEL "CONTROL" SMALL	790867000
70	"TOP" LABEL	790844000
71	"RATING PLATE" LABEL	790829000
72	LABEL - HONEYWELL L7224/L7248 AQUASTAT	790868000
80	M1: LB 8-10KW 1-PH ELECTRIC BOILER PARTITION ASSY	795122110
81	M1: LB 12-15KW 1-PH ELECTRIC BOILER PARTITION ASSY	795122115
82	M1: LB 16-20KW 1-PH ELECTRIC BOILER PARTITION ASSY	795122120
83	M1: LB 24-25KW 1-PH ELECTRIC BOILER PARTITION ASSY	795122125
84	M1: LB 12-15KW 3-PH ELECTRIC BOILER PARTITION ASSY	795122315
85	M1: LB 16-20KW 3-PH ELECTRIC BOILER PARTITION ASSY	795122320
86	M1: LB 24-25KW 3-PH ELECTRIC BOILER PARTITION ASSY	795122325
87	M1: LB 28-30KW 3-PH ELECTRIC BOILER PARTITION ASSY	795122330
88	M1: LB 32-35KW 3-PH ELECTRIC BOILER PARTITION ASSY	795122335
89	M1: LB 40KW 3PH ELECTRIC BOILER PARTITION ASSY	795122340
90	M1 (LB): RIGHT FRONT COVER	790046000
91	FUSE HOLDER PANEL MOUNT (SEE LB CONFIGURATIONS)	790120000
92	FUSE - 15A (SEE LB CONFIGURATIONS)	790100100
100	WALL BRACKET	790736000
*101	M1 PLUMBING PACKAGE	790850001
*102	M1 LITERATURE PACKAGE	792808000

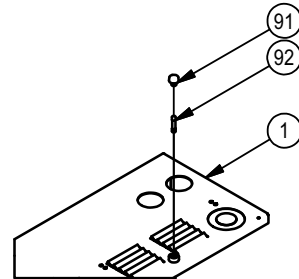
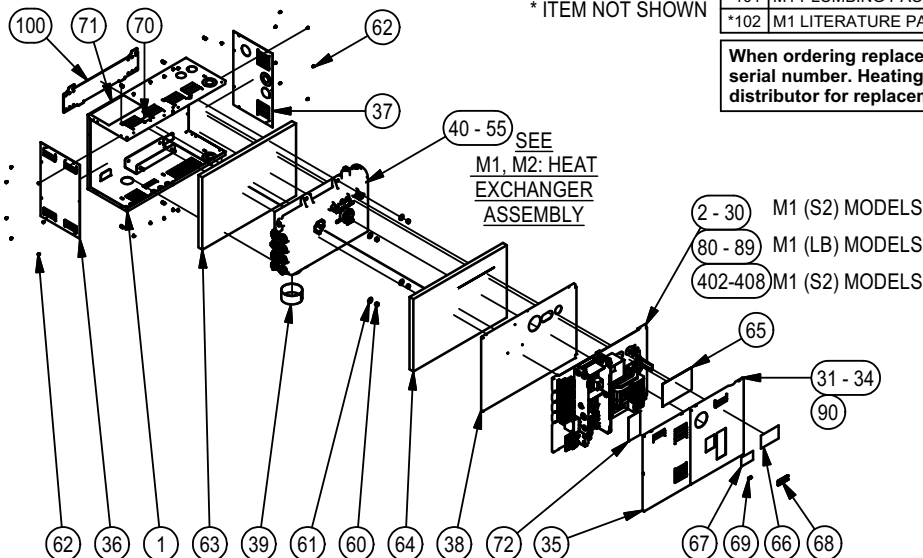

M1 (LB) WRAPPER WITH FUSE

PART NO. 790922000  
(REF EH-S2-10PL) REV B

# M1 (S2): ELECTRIC PARTITION ASSEMBLIES

ITEM	DESCRIPTION	PART NO.
201	M1 (S2, LB): CENTER PARTITION CLINCH NUT ASSY	795124000
202	M1 (S2, LB): RELAY PARTITION	790010000
203	M1 (S2, LB): SERVICE PARTITION	790008000
204	M1 (S2, LB): BRACKET ASSEMBLY - LINE VOLTAGE (120V)	790018000
205	M1 (S2, LB): BRACKET - LOW VOLTAGE TERMINAL (24V)	790013000
206	M1, M2: GAUGE HOUSING	790009000
207	M1: MOUNTING BRACKET FOR HONEYWELL CONTROL	790909000
208	CIRCUIT BREAKER BASE- SINGLE PHASE 125A	790311000
209	CIRCUIT BREAKER BASE- SINGLE PHASE 200A	790312000
210	CIRCUIT BREAKER BASE- THREE PHASE	790313000
211	CIRCUIT BREAKER 15A SP GE THQL1115	790335100
212	CIRCUIT BREAKER 25A DP GE THQL2125	790314000
213	CIRCUIT BREAKER 30A DP GE THQL2130	790315000
214	CIRCUIT BREAKER 50A DP GE THQL2150	790316000
215	CIRCUIT BREAKER 60A DP GE THQL2160	790317000
216	TRANSFORMER: 40VA-120/24V W/TERMINALS	790343000
217	TRANSFORMER: 50VA-120/24V W/TERMINALS	790344100
218	CONTACTOR HONEYWELL R8246A1004 24V	790322000
219	TIME DELAY RELAY 15SH1 309572	790847000
221	M1: TERMINAL BLOCK ASSEMBLY 4 POLE (LINE VOLTAGE) 120V	790339000
222	M1: TERMINAL BLOCK ASSEMBLY 6-POLE (LOW VOLTAGE) 24V	790340000
223	DOUBLE TERMINAL CONNECTOR	790567000
225	EQUIPMENT SOLDERLESS LUG 2/0 AWG	790280000
226	SCREW 1/4-20 X 5/8 HEX ZN PLATED GRADE 5	790281000

ITEM	DESCRIPTION	PART NO.
228	HONEYWELL AQUASTAT L7248L1105 (100°-240°F HI-LIMIT)	790379000
229	SCREW 8x3/8 HEX WASHER ZN PLATE TYPE B	790834000
230	GROUND SCR10-32x3/8 GREEN GND	65 0666 000
233	SCREW 8 X 1/2 HEX WASHER SLOT ZINC TYPE B	790913000
234	WASHER-TERMINAL CUP #10 BRASS	790838000
238	STUD 1/4-20 X 3/4 ZINC PL.	790139000
239	STANDOFF INSULATOR 1" (1/4-20 X 5/16)	790266000
240	HEX HEAD CAP SCREW 1/4-20 X 3/8 ZN PLATED GRADE 5	790285000
245	SNAP BUSHING Ø7/8" HOLE X .69" ID	50 0385 000
246	SNAP BUSHING Ø1.125 HOLE X .875" ID	500373000
248	"GROUND" LABEL - SMALL	790858000
249	M1: LABEL - LOW VOLTAGE TERMINAL BLOCK (24V)	790863000
250	M1: LABEL - LINE VOLTAGE TERMINAL BLOCK (120V)	790862000
251	LABEL "L1, L2"	790849000
252	LABEL "NEUTRAL"	790845000
254	LABEL "L1" SMALL	790864000
255	LABEL "L2" SMALL	790865000
256	LABEL "L3" SMALL	790866000
259	SCREW 10-32 X 3/8" PAN HD PHILLIPS ZN PLT	790286000
260	SCREW 8-32 X 5/8" PAN HD PHILLIPS ZN THREAD FORMING	790914000
277	HONEYWELL SENSOR 24" LONG	790406000

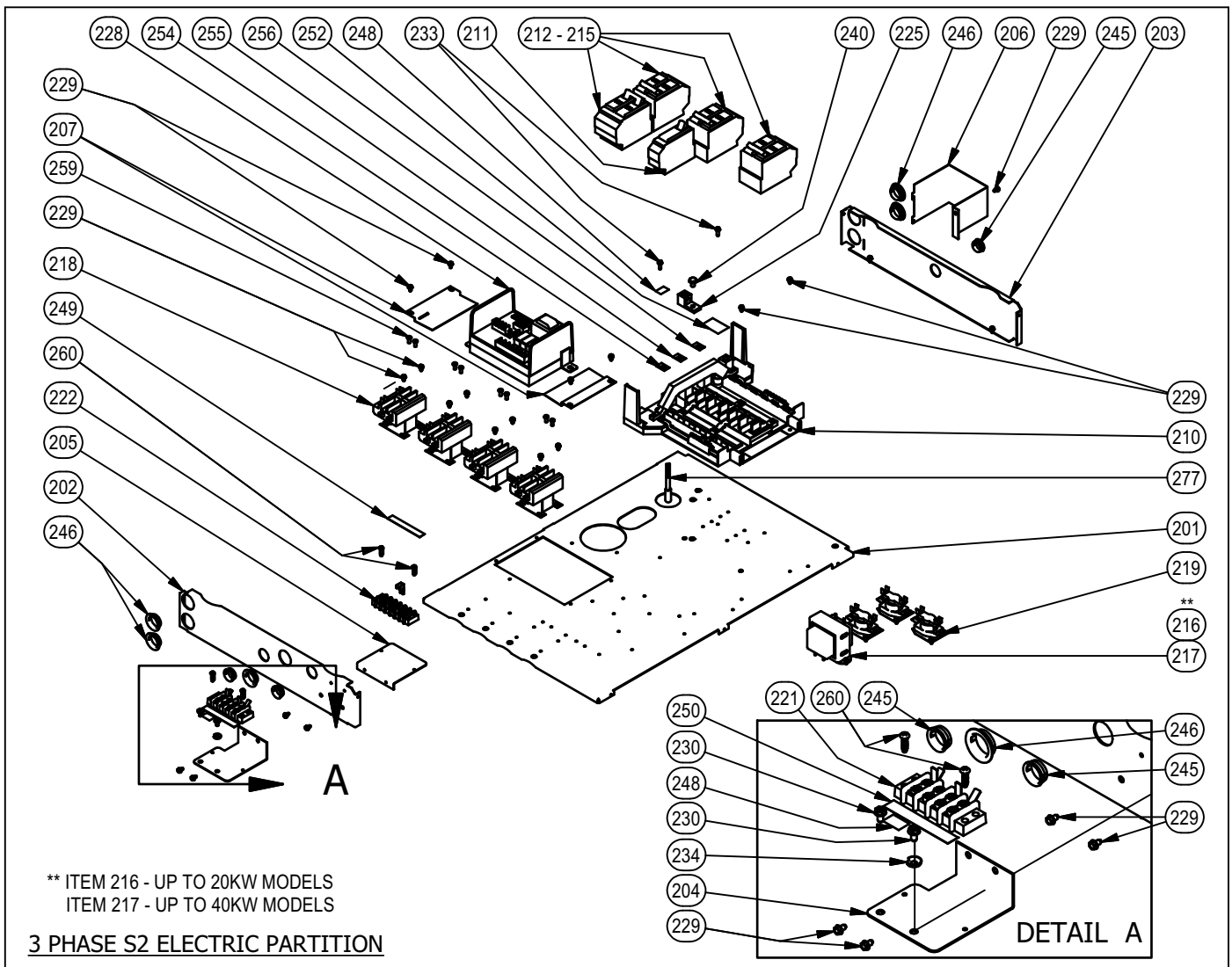

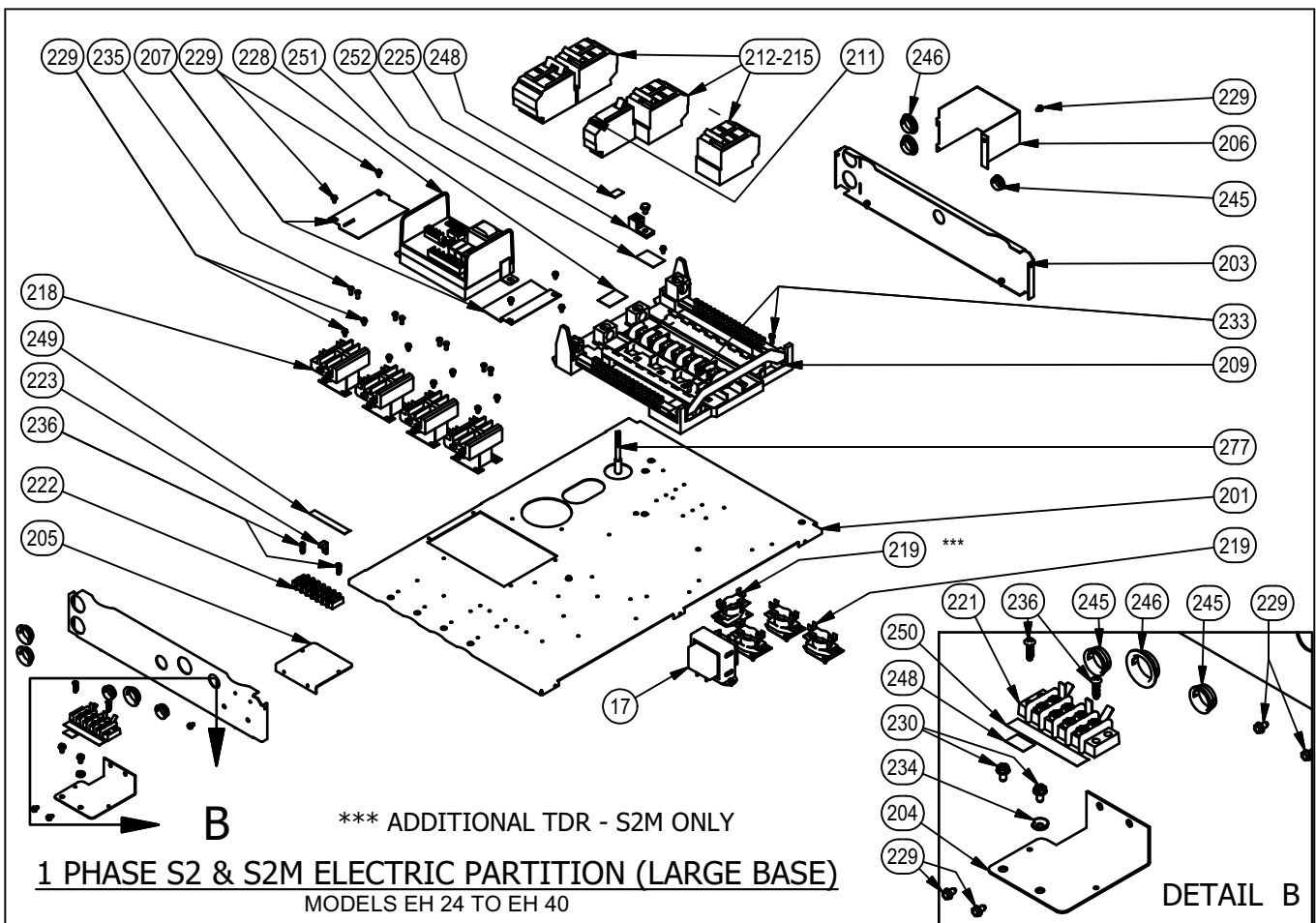
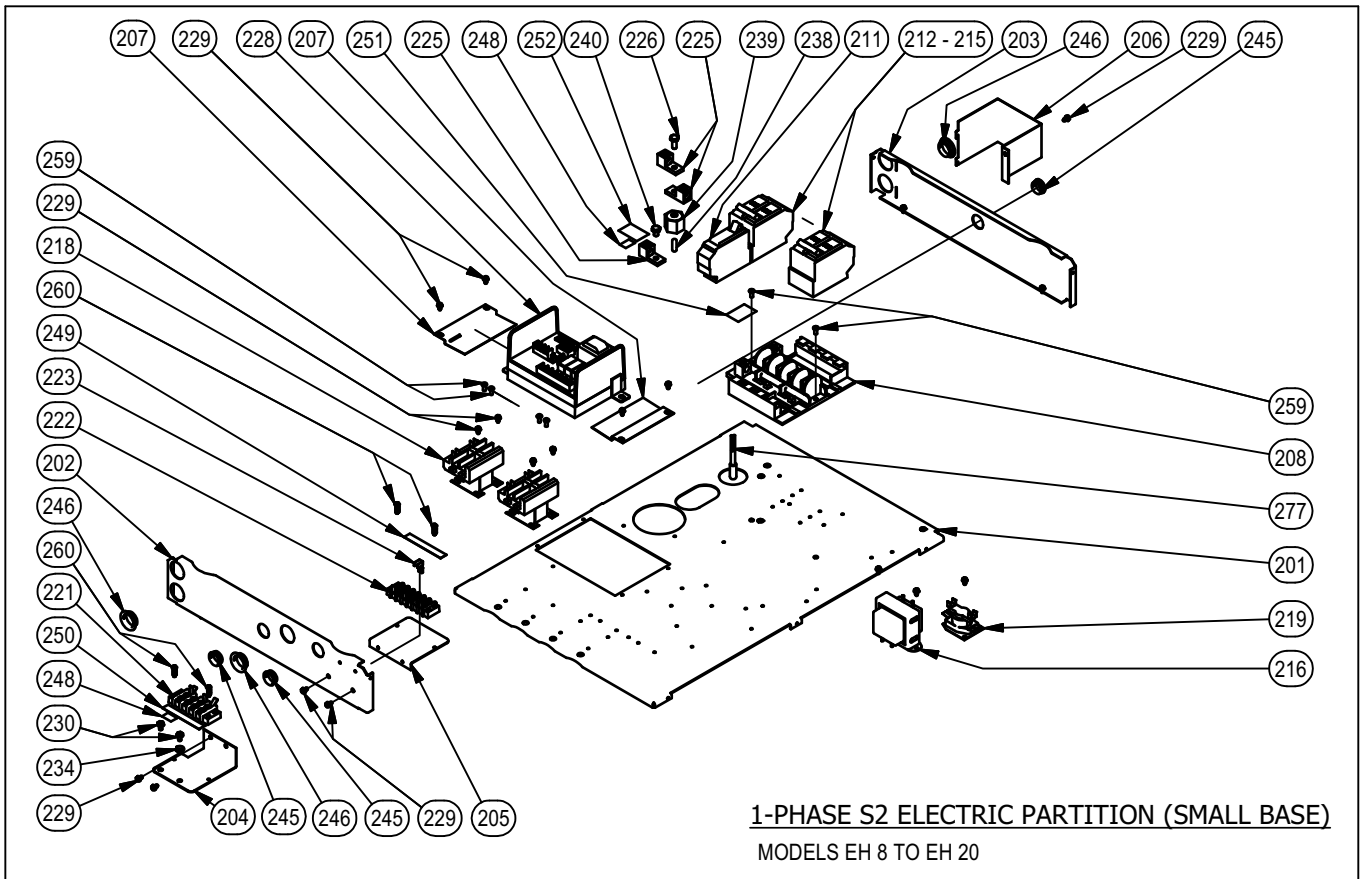

# M1 (LB): ELECTRIC PARTITION ASSEMBLY

ITEM	DESCRIPTION	PART NO.
201	M1 (S2, LB): CENTER PARTITION ASSY	795124000
202	M1 (S2, LB): RELAY PARTITION	790010000
203	M1 (S2, LB): SERVICE PARTITION	790008000
204	M1 (S2, LB): BRACKET ASSEMBLY - LINE VOLTAGE (120V)	790018000
205	M1 (S2, LB): BRACKET - LOW VOLTAGE TERMINAL (24V)	790013000
206	M1, M2: GAUGE HOUSING	790009000
207	M1: MOUNTING BRACKET FOR HONEYWELL CONTROL	790909000
208	MINI POWER DISTRIBUTION BLOCK SINGLE PH. 2-POLE 175A(UL)	790387002
209	MINI POWER DISTRIBUTION BLOCK 3-PHASE 3-POLE 175A(UL)	790387003
216	TRANSFORMER: 40VA-120/24V W/TERMINALS	790343000
217	TRANSFORMER: 50VA-120/24V W/TERMINALS	790344100
218	CONTACTOR HONEYWELL R8246A1004 24V	790322000
219	TIME DELAY RELAY 15SH1 309572	790847000
221	M1: TERMINAL BLOCK ASSEMBLY 4 POLE (LINE VOLTAGE) 120V	790339000
222	M1: TERMINAL BLOCK ASSEMBLY 6-POLE (LOW VOLTAGE) 24V	790340000
223	DOUBLE TERMINAL CONNECTOR	790567000
224	SCREW 8-32 X 5/8" PAN HD PHILLIPS ZN THREAD FORMING	790914000

ITEM	DESCRIPTION	PART NO.
225	EQUIPMENT SOLDERLESS LUG 2/0 AWG	790280000
226	SCREW 1/4-20 X 5/8 HEX ZN PLATED GRADE 5	790281000
228	HONEYWELL AQUASTAT L7248L1105 (100°-240°F HI-LIMIT)	790379000
229	SCREW 8x3/8 HEX WASHER ZN PLATE TYPE B	790834000
230	GROUND SCR10-32x3/8 GREEN GND	65 0666 000
231	SCREW 8 X 1/2 HEX WASHER SLOT ZINC TYPE B	790913000
234	WASHER-TERMINAL CUP #10 BRASS	790838000
238	STUD 1/4-20 X 3/4 ZINC PL.	790139000
239	STANDOFF INSULATOR 1" (1/4-20 X 5/16)	790266000
240	HEX HEAD CAP SCREW 1/4-20 X 3/8 ZN PLATED GRADE 5	790285000
245	SNAP BUSHING Ø7/8" HOLE X .69" ID	50 0385 000
246	SNAP BUSHING Ø1.125 HOLE X .875" ID	500373000
248	"GROUND" LABEL - SMALL	790858000
249	M1: LABEL - LOW VOLTAGE TERMINAL BLOCK (24V)	790863000
250	M1: LABEL - LINE VOLTAGE TERMINAL BLOCK (120V)	790862000
251	LABEL "L1, L2"	790849000
252	LABEL "NEUTRAL"	790845000
253	"L3" LABEL (3-PHASE MODELS ONLY)	790851000
257	"GROUND" LABEL	790846000
259	SCREW 10-32 X 3/8" PAN HD PHILLIPS ZN PLT	790286000
277	HONEYWELL SENSOR 24" LONG	790406000

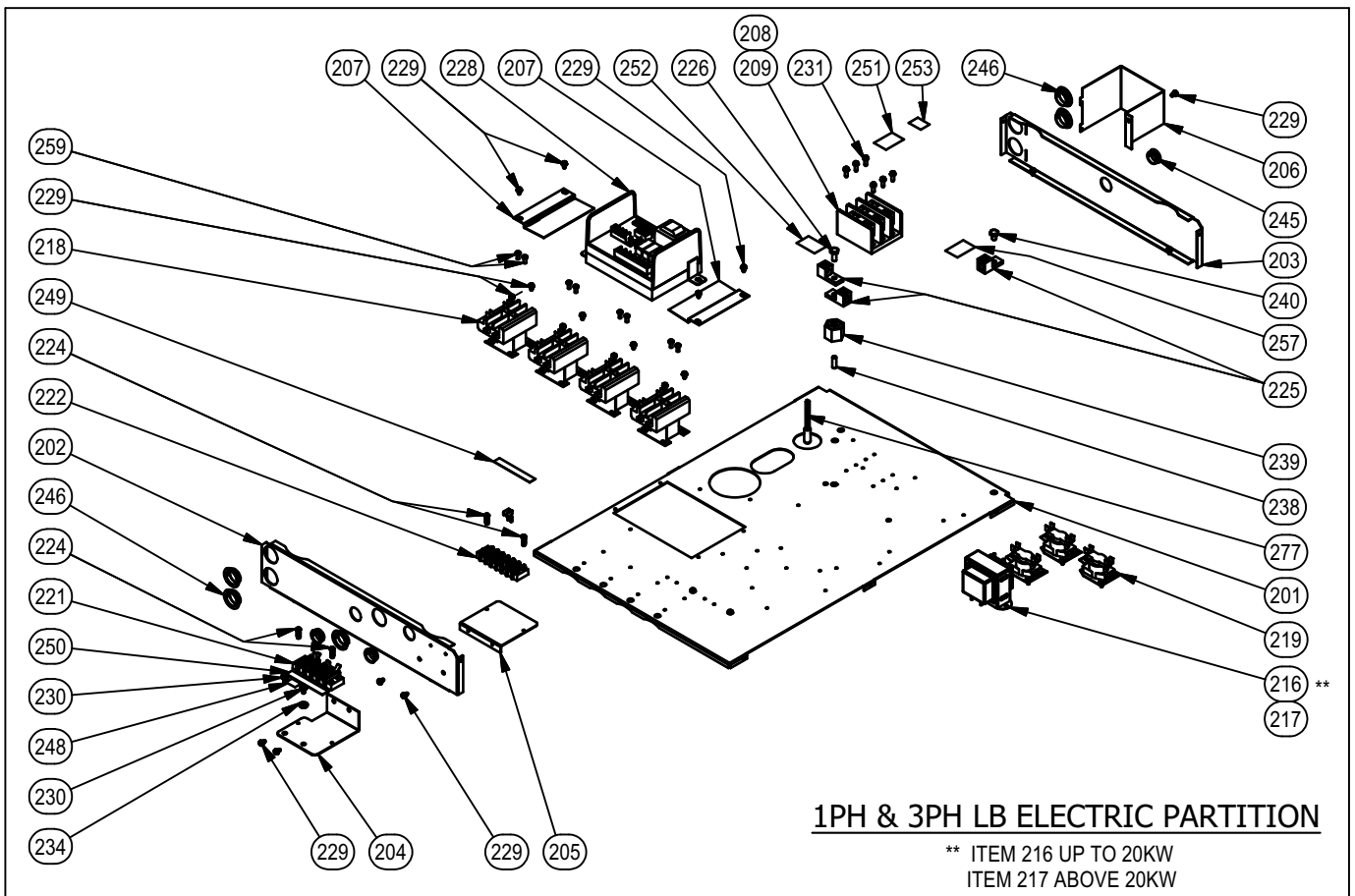

# M1, M2: HEAT EXCHANGER ASSEMBLY

ITEM	TITLE	PART NO.
301	HEAT EXCHANGER 4-HOLE	796002400
302	HEAT EXCHANGER 6-HOLE	796002600
303	HEAT EXCHANGER 8-HOLE	796002800
304	HEATER ELEMENT 4kW 240V	790304000
305	HEATER ELEMENT 5kW 240V	790305000
306	BLANK SCREW PLUG	790306000
307	HEATER ELEMENT GASKET	790303000
308	REDUCING BUSHING 1/2 x 1/4 (BL.MALLEABLE)	902179051
309	TRIDICATOR	910373061
310	HIGH LIMIT CONTROL SENSOR	790398000
311	COUPLING EXTENTION 1/2 x 1/2	790106000
312	IMMERSION WELL 1/2" NPT X 1.5"	790099000
313	H-CLIP WIRE RETAINER FOR IMMERSION WELL	790119000
314	1/2" NPT PLUG-SQUARE HEAD	400239000

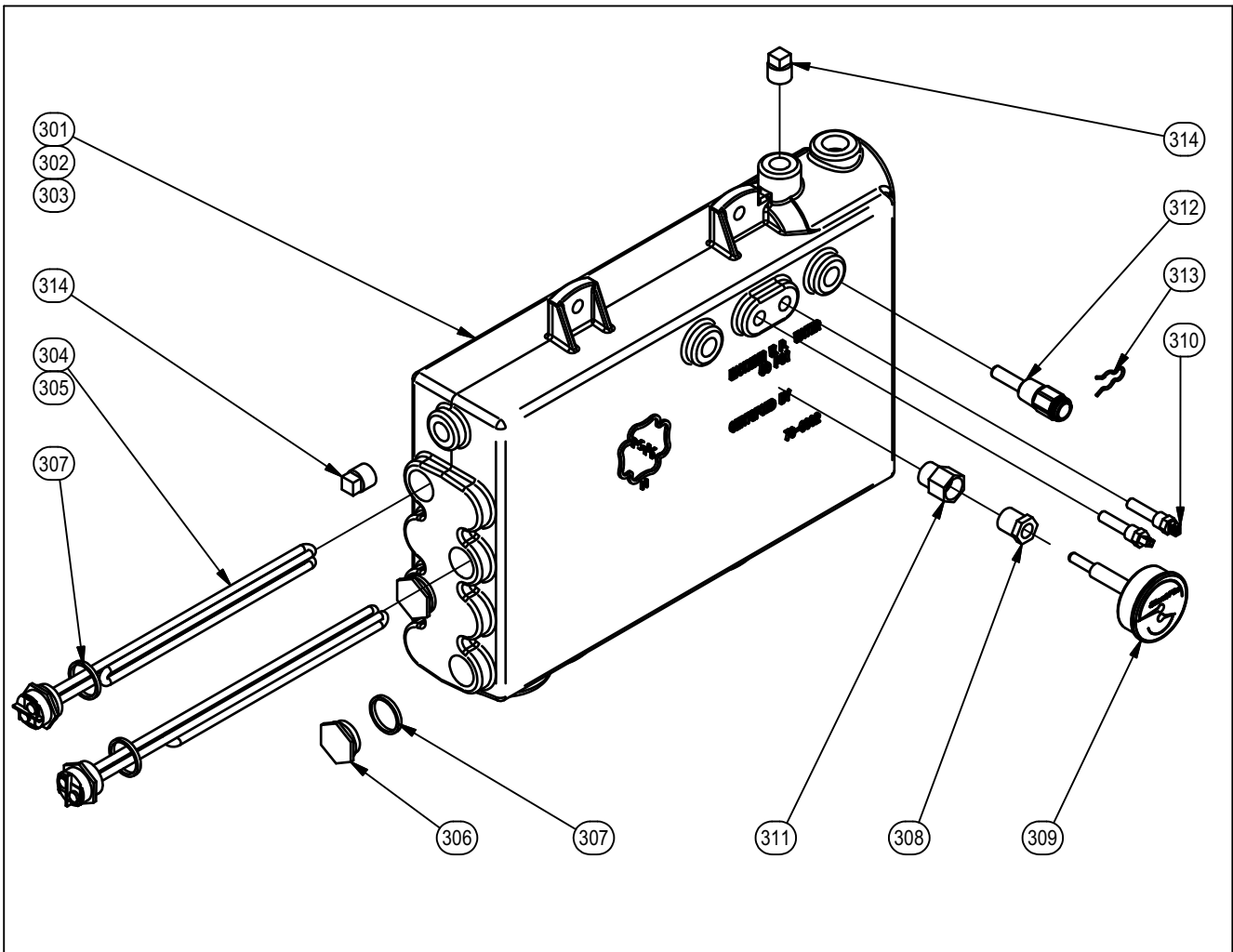

# M1 (S2): SINGLE PHASE CONFIGURATIONS

\*kW values are 240V ratings

Model	Type	Elements*	CB1	CB2	CB3	CB4	CB5
EH8-135-S2	1P2E	2 X 4kW	15A	50A	-	-	-
EH9-135-S2	1P2E	1X4kW, 1X5kW	15A	50A	-	-	-
EH10-135-S2	1P2E	2 X 5kW	15A	60A	-	-	-
EH12-135-S2	1P3E	3 X 4kW	15A	50A	25A	-	-
EH15-135-S2	1P3E	3 X 5kW	15A	60A	30A	-	-
EH16-135-S2	1P4E	4 X 4kW	15A	50A	50A	-	-
EH18-135-S2	1P4E	2X4kW, 2X5kW	15A	50A	50A	-	-
EH20-135-S2	1P4E	4 X 5kW	15A	60A	60A	-	-

FOR MODEL SPECIFIC ELEMENT & COMPONENT CONFIGURATIONS SEE ELECTRIC DIAGRAM INSIDE THE RIGHT FRONT COVER

Model	Type	Elements*	CB1	CB2	CB3	CB4	CB5
EH24-135-S2	1P5E	1X4kW, 4X5kW	15A	50A	30A	60A	-
EH25-135-S2	1P5E	5 X 5kW	15A	60A	30A	60A	-
EH28-135-S2	1P6E	2X4kW, 4X5kW	15A	50A	50A	60A	-
EH30-135-S2	1P6E	6 X 5kW	15A	60A	60A	60A	-
EH32-135-S2	1P7E	3X4kW, 4X5kW	15A	30A	50A	50A	50A
EH35-135-S2	1P7E	7 X 5kW	15A	30A	60A	60A	60A
EH40-135-S2	1P8E	8 X 5kW	15A	60A	60A	60A	60A

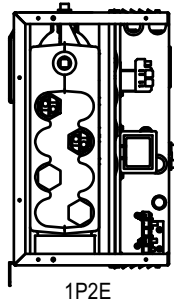

1P2E

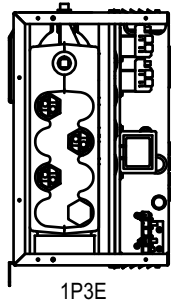

1P3E

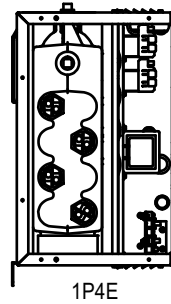

1P4E

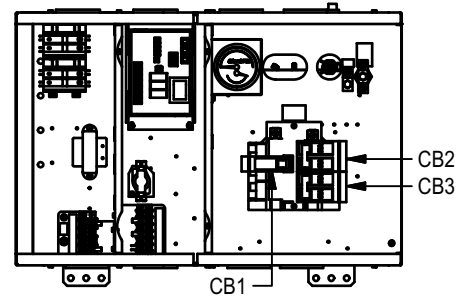

EH8 - EH20 1-PHASE SMALL BREAKER BASE

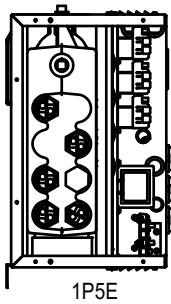

1P5E

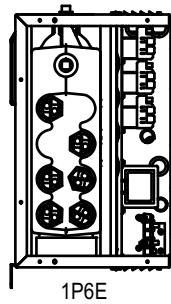

1P6E

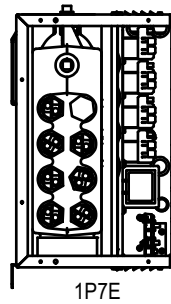

1P7E

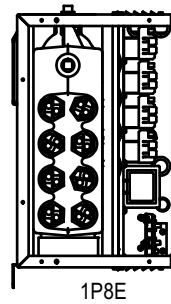

1P8E

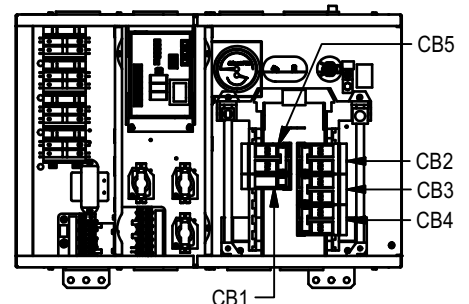

EH24 - EH40 1-PHASE LARGE BREAKER BASE

# M1 (S2): THREE PHASE CONFIGURATIONS

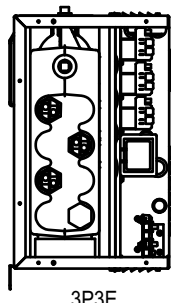

3P3E

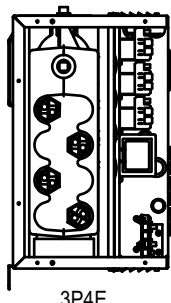

3P4E

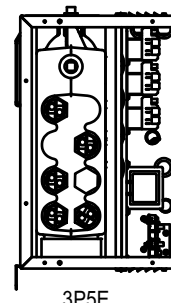

3P5E

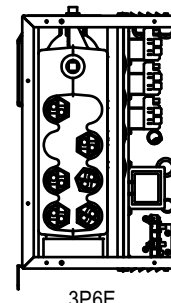

3P6E

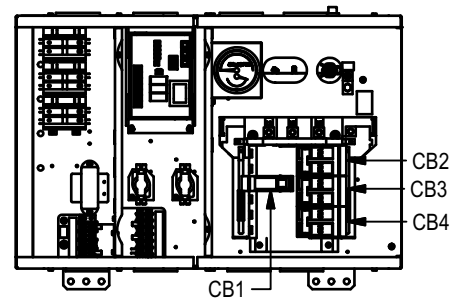

EH 12 - EH 30 3-PHASE BREAKER BASE

Model	Type	Elements*	CB1	CB2	CB3	CB4	CB5
EH12-345-S2	3P3E	3 X 4kW	15A	25A	25A	25A	-
EH15-345-S2	3P3E	3 X 5kW	15A	30A	30A	30A	-
EH16-345-S2	3P4E	4 X 4kW	15A	25A	25A	50A	-
EH18-345-S2	3P4E	2X4kW, 2X5kW	15A	25A	30A	50A	-
EH20-345-S2	3P4E	4 X 5kW	15A	30A	30A	60A	-
EH24-345-S2	3P5E	4X5kW, 1X4kW	15A	50A	30A	60A	-
EH25-345-S2	3P5E	5X5kW	15A	60A	30A	60A	-
EH28-345-S2	3P6E	4X5kW, 2X4kW	15A	50A	50A	60A	-
EH30-345-S2	3P6E	6X5kW	15A	60A	60A	60A	-
EH32-345-S2	3P7E	4X5kW, 3X4kW	15A	30A	50A	50A	50A
EH35-345-S2	3P7E	7 X 5kW	15A	30A	60A	60A	60A
EH40-345-S2	3P8E	8 X 5kW	15A	60A	60A	60A	60A

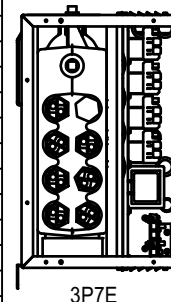

3P7E

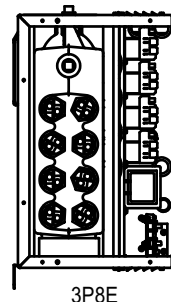

3P8E

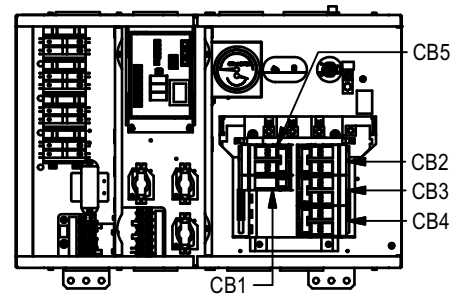

EH 32 - EH 40 3-PHASE BREAKER BASE

# M1 (LB): SINGLE PHASE CONFIGURATIONS

\*kW values are 240V ratings

Single Phase Models		
Model	Type	Elements*
EH8-135-LB	1P2E	2 X 4kW
EH9-135-LB	1P2E	1X4kW,1X5kW
EH10-135-LB	1P2E	2 X 5kW
EH12-135-LB	1P3E	3 X 4kW
EH15-135-LB	1P3E	3 X 5kW
EH16-135-LB	1P4E	4 X 4kW
EH18-135-LB	1P4E	2X4kW,2X5kW
EH20-135-LB	1P4E	4 X 5kW
EH24-135-LB	1P5E	1X4kW,4X5kW
EH25-135-LB	1P5E	5 X 5kW

FOR MODEL SPECIFIC ELEMENT & COMPONENT CONFIGURATIONS SEE ELECTRIC DIAGRAM INSIDE THE RIGHT FRONT COVER

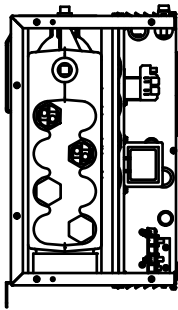

1P2E

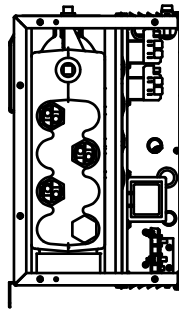

1P3E

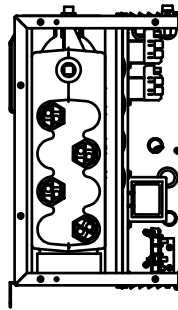

1P4E

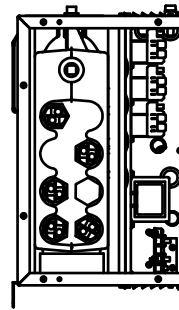

1P5E

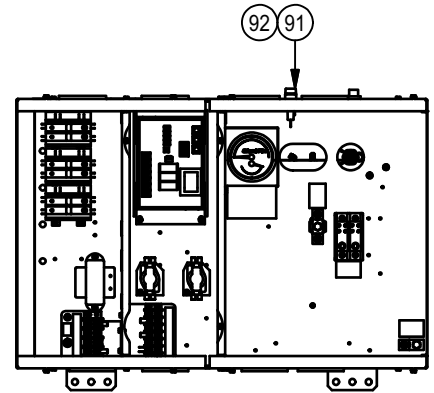

EH LB SINGLE PHASE MODELS

# M1 (LB): THREE PHASE CONFIGURATIONS

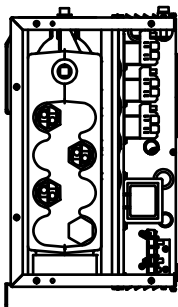

3P3E

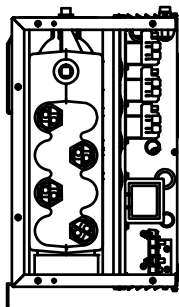

3P4E

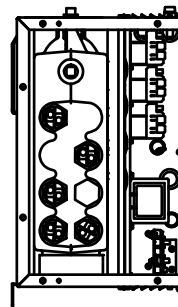

3P5E

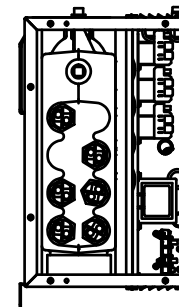

3P6E

\*kW values are 240V ratings

Three Phase Models		
Model	Type	Elements*
EH12-345-LB	3P3E	3 X 4kW
EH15-345-LB	3P3E	3 X 5kW
EH16-345-LB	3P4E	4 X 4kW
EH18-345-LB	3P4E	2X4kW,2X5kW
EH20-345-LB	3P4E	4 X 5kW
EH24-345-LB	3P5E	4X5kW, 1X4kW
EH25-345-LB	3P5E	5X5kW
EH28-345-S2	3P6E	4X5kW, 2X4kW
EH30-345-S2	3P6E	6X5kW
EH32-345-S2	3P7E	4X5kW, 3X4kW
EH35-345-S2	3P7E	7 X 5kW
EH40-345-S2	3P8E	8 X 5kW

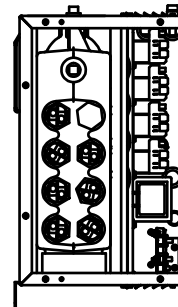

3P7E

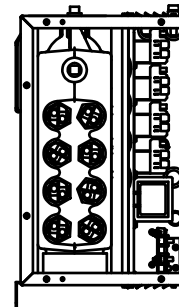

3P8E

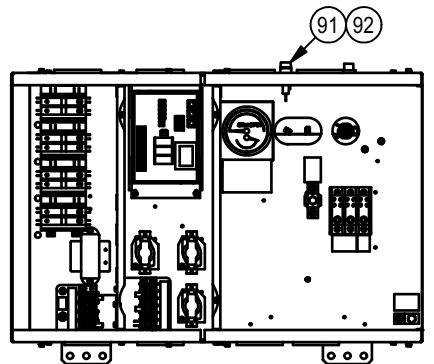

EH LB THREE PHASE MODELS

# M1 (S2M): SINGLE PHASE CONFIGURATIONS

Model	Type	Elements*	CB1	CB2	CB3	CB4	CB5
EH24-135-S2M	1P5E	1X4kW,4X5kW	15A	50A	30A	60A	-
EH25-135-S2M	1P5E	5 X 5kW	15A	60A	30A	60A	-
EH28-135-S2M	1P6E	2X4kW,4X5kW	15A	50A	50A	60A	-
EH30-135-S2M	1P6E	6 X 5kW	15A	60A	60A	60A	-
EH32-135-S2M	1P7E	3X4kW,4X5kW	15A	30A	50A	50A	50A
EH35-135-S2M	1P7E	7 X 5kW	15A	30A	60A	60A	60A
EH40-135-S2M	1P8E	8 X 5kW	15A	60A	60A	60A	60A

FOR MODEL SPECIFIC ELEMENT & COMPONENT CONFIGURATIONS SEE ELECTRIC DIAGRAM INSIDE THE RIGHT FRONT COVER

